

PLOTTED: Tuesday, April 13, 2021 @ 07:59PM

J:\PROJECTS\2018\1801010541 BEL AIRE WOODLAWN 37TH TO 45TH\180541 CAD\SHITS\05 CIVIL\180541-TC-5707.DWG

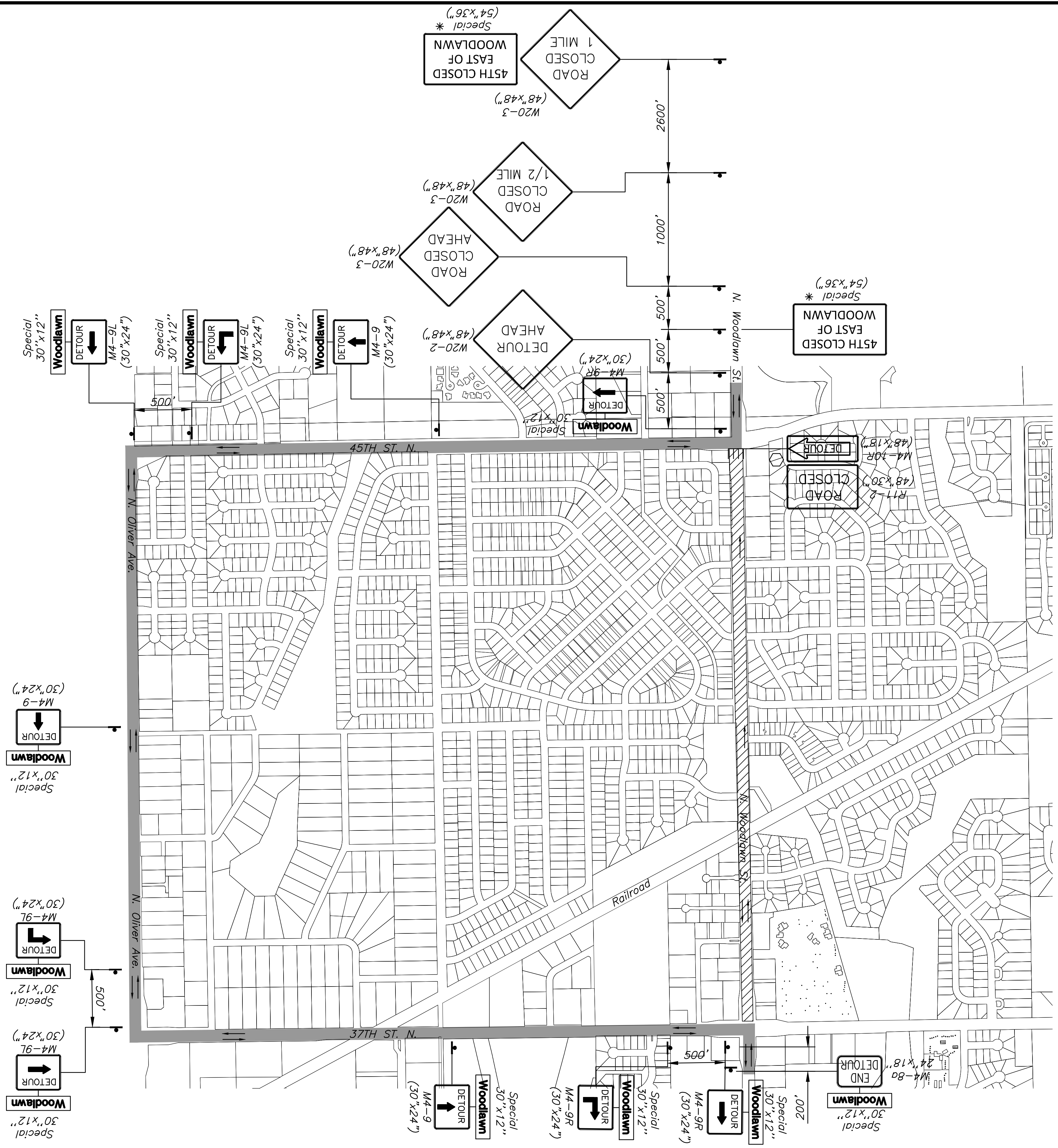

WOODLAWN DETOUR - PHASE 2

STATE	PROJECT NO.	YEAR	SHEET NO.	TOTAL SHEETS
KANSAS	87 N-0678-01	2021	167	230

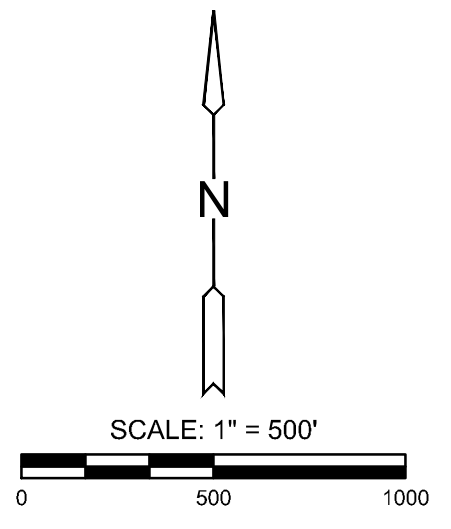

* Signs to be erected during implementation of the 45th Street detour.

LEGEND

	Work Zone
	Traffic Flow
	Traffic Barricades
	Sign
	Mount on Traffic Barricades

STREET IMPROVEMENTS FOR
WOODLAWN - 37TH ST. N. TO 45TH ST. N.
 BEL AIRE, KS

©2020 MKEC Engineering All Rights Reserved
 www.mkec.com
 These drawings and their contents, including, but not limited to, all concepts, designs, & ideas are the exclusive property of MKEC Engineering (MKEC), and may not be used or reproduced in any way without the express consent of MKEC.

TRAFFIC DETOUR PLAN - PHASE 2

PROJECT NO.	87 N-0678-01	
DATE	8/11/20	
SCALE	1"=500'	
DESIGNED	DRAWN	CHECKED
JRA	RAM	JRA
NO.	REVISION	DATE

SHEET NO.
 167 OF 230